

Lucoflex PIN CONNECTOR INSTALLATION GUIDE



LUCOLED
Experience Lighting

Lucoflex LED neon replacement is easy to install in straight or curved spaces in both indoor and outdoor conditions. It creates a uniform, bright, neon-alternative effect.

Please read these guidelines completely before installing.

It is important to read these guidelines completely to understand how Lucoflex can be configured, cut to size, re-connected, and installed so you can design your own LED lighting layout.

- NEVER attempt any work without shutting off the electricity. Use only with low voltage
- 24V DC power source supplied by Lucoled.
- Do not stare directly into the LED lights when illuminated. Do not power Lucoflex while still coiled on reel. This can damage the product.
- Always observe polarity for connections, positive (+) to positive and negative (-) to negative.
- To be installed by a qualified electrician.
- Keep away from combustible materials such as plastic or paper products.

All wiring must be in accordance with national and local electrical codes, low voltage Class 2 circuit. If you are unclear as to how to install and wire this product, contact a qualified professional.



Unpacking

Rolling the wheel when you unpacking the light.

*Warning: Do NOT shake the light!
Do NOT pull the light from the wheel straightly.*



No Twisting

Lucoflex is NOT allow to twisted in any conditions. The electrical circuit or LED chips could be damaged with this action.



Bending

Lucoflex can only be bent laterally (opposite bent along to light surface).

Do not bend smaller than allowed minimum bend diameter. The electrical circuit or LED chips could be damaged if bending diameter is too small.

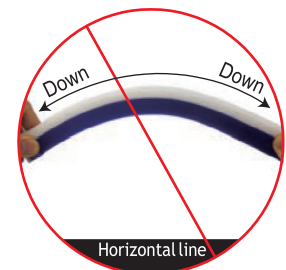
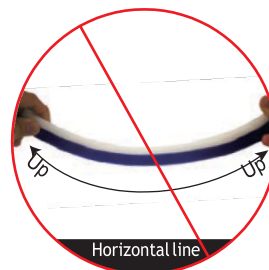

Incorrect Bending

Lucoflex is NOT allow to bending in up and down way.

The bending as photos show will damage the electrical circuit or LED chips damaged seriously by this incorrect action.



CUTTING

Lucoflex's 24V DC cuttable length is every 5cm.

Use a pipe or branch cutter to cut Lucoflex on the scissor cut marks.



PIN CONNECTOR INSTALLATION



Remove PET tape

Use a small knife to remove the PET tape from the back of the flexible circuit board to create space for the connection pins.

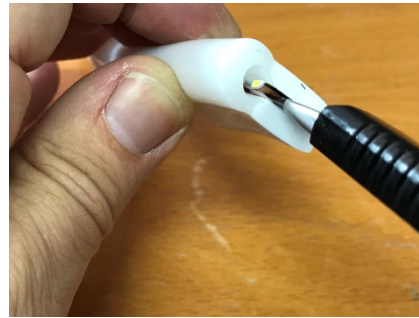

Create space between PET tape and PCB



Insert pin connector

Insert the pin connector between the PET tape and the copper connections on the board. Make sure the pins touch the copper.



Apply silicon

Apply a silicon layer on all sides of the tube.

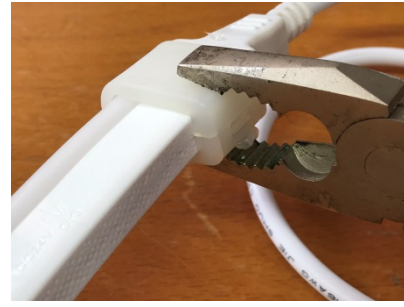
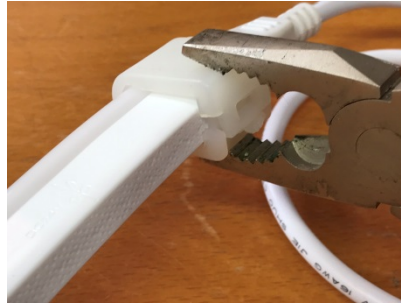
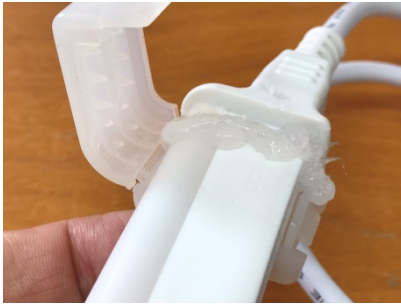

Install cover

Install the cover with the large opening facing towards the Lucoflex. Close firmly with a plier.

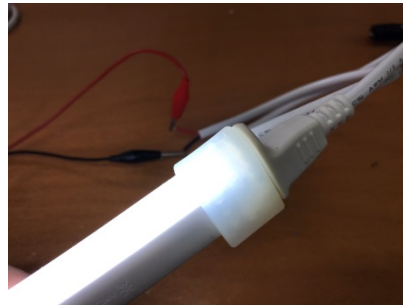

Finish

Remove excess silicon and test the connection before installation.

Lucoflex

INSTALLATION GUIDE

WET
LOCATION

DC
ONLY

Welcome to Lucoflex Lighting

Lucoflex Lighting is easy to install in straight, horizontal curved spaces where humidity or outdoor conditions. It's creates hot-spot free, smooth, warm and relaxing environments or delivers bright task lighting.

Please read these guidelines completely before installing.

It is important to read these guidelines completely to understand how it can be configured, cut to size, re-connected, and installed so you can design your LED lighting layout.

- NEVER attempt any work without shutting off the electricity.
- Use only with low voltage 24V DC power source
- Do not stare directly into the LED lights when illuminated
- Do not power LED tape while coiled on reel
- Always observe polarity for connections, positive (+) to positive and negative (-) to negative
- To be installed by a qualified electrician.
- Keep away from combustible materials such as plastic or paper products.

All wiring must be in accordance with national and local electrical codes, low voltage Class 2 circuit. If you are unclear as to how to install and wire this product, contact a qualified professional.



Unpacking

Rolling the wheel when you unpacking the light.

*Warning: Do NOT shake the light!
Do NOT pull the light from the wheel straightly.*

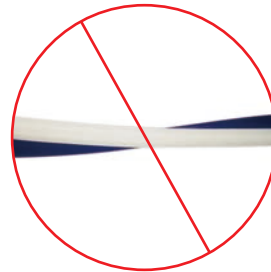

No Twisting

Lucoflex is NOT allow to twisted in any conditions. The electrical circuit or LED chips could be damaged with this action.



Bending

Lucoflex can only be bent laterally (opposite bent along to light surface).

Do not bend smaller than allowed min bend dia.

The electrical circuit or LED chips could be damaged if bending diameter is too small.

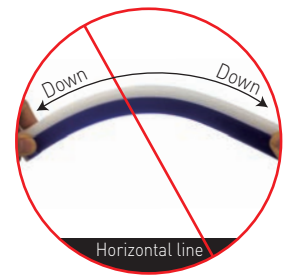
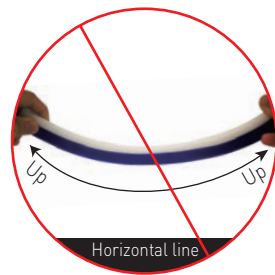

Incorrect Bending

Lucoflex is NOT allow to bending in up and down way.

The bending as photos show will damage the electrical circuit or LED chips damaged seriously by this incorrect action.

Lucoflex

INSTALLATION GUIDE

WET
LOCATION

DC
ONLY

CUTTING

Lucoflex's cuttable length in each 5cm.
Use the Ratcheting Cutter to cut the Lucoflex wherever a Laser marked Scissors.
Please keep a sharp and clean edge.



INPUT CABLE AND END CAPS INSTALLATION

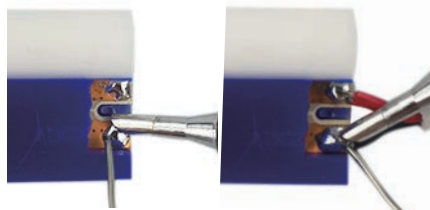

Remove the Silicone

Use the knife to carefully remove the Silicone on the top. Scrape lightly on the copper pads to make sure there is no glue left. If any glue is left, it will be difficult to solder the cables.

Input Cable Soldering

Add a small round puddle of solder on the top of two copper pads.
Solder a positive and negative cable to the positive and negative solder pads.



RE-CONNECTION



Found the mark side by laser in **[Pin This Side]**.
Inset the gold coated Pin to the 2 cut light end. Make sure the Pin touch the copper pads well. There is one set of the straight joiner kit included in each package in 15m. [shortger length is offering separately]



Fill the Crocodile cap full way with glue. Make sure there is no blank spaces.
Close the cap by pushing 2 sides together, make sure the teeth on the buttom bite well.

Seal End Cap

Take the end cap and fill it half way with glue. Insert the cap on the end of the Lucoflex until the inner back wall of the end cap is touching the end of the light. Seal the edge of the end caps if there is any blank spaces.
Wipe the left over glue around the end cap on a paper towel.

Remark:
If no further modifications to the strip are necessary, then the light needs to dry before installation.
We recommend at least 24 hours of drying time to ensure the glue fully cures.

Attention

The controller outputs about 512-800 points on each port, and no more than 800pcs on each port. Each port is independently equipped with a power supply, which is not Shared with other ports.

The Standard Packing Quantity of RGB lights is 30pcs, and each string must be connected to the power supply.

The power wire should be 2.5 square meters of national standard multi-core pure copper wire. Make sure the correct connection of positive and negative poles between led module and power supply. Treat the Exposed wires with insulation arrangement

The controller needs to choose the products of regular manufacturers, and the signal output to the lamp must use our special signal extension wire, not inferior network cable, common cable or telephone wire.

The power supply must have short circuit protection, overvoltage protection, overload protection and other functions, the output voltage must be the same as the working voltage of the lamp string, the rated load power must reserve 20% of the margin.

The lightning protection scheme, leakage protection, timing and other supporting works of the overall project shall be designed and constructed by professional departments. The resulting product problems do not belong to the scope of our warranty.

Common Faults and Troubleshoot

Problems	Reasons	Solutions
All LEDs can not light on.	Automatic power protection from the open or short circuit in output of the power supply	Check the circuit for short circuits
	Wrong connection of power supply.	Check the correctness of positive and negative connection
	Some IC do not light up when they are charged	Check IC model
LEDs can not light on partly	Some switching mode power supplies are not powered.	Check wiring is correct
	Wrong connection of power supply.	Check if the line is connected to the power supply
Picture shaking and clutter	wrong IC model for the controller	Confirm IC model rewrite program
	The controller and the wire of the lamp are connected incorrectly.	green line and blue line DATA, black line GND
picture shake and flicker	The lamp is not installed in the right way	Check the wiring
	The signal cables are ordinary cables	Replace the network cable with shielding function
	The lamp is overloaded	2.5 square meters of national standard multi-core pure copper wire
	The power supply is poor and unstable	Replace high quality power supply
Signal instability	Two power supplies per port	One power supply per port
Single lamp no signal	The signal cables are ordinary cables	Replace the lamp
single lamp flickers dim	The lamp is overloaded	Replace the lamp
Abnormal color of single lamp	The power supply is poor and unstable	Replace the lamp
repaired every month	Low IC chip quality	Replace the regular light string manufacturers
no signal when it rains	Induction short circuit or lamp not waterproof	Check the lamp board for rust
No signal for half a year	Poor contact due to rusting of lamp board	Choose the manufacturer of waterproof lamp board
High signal failure rate in winter	Cold and heat shock causes poor IC signal	Choose IC high protection manufacturers

Warranty statement

Product life span under normal usage

If the product is damaged due to its own quality problems within the warranty period (excluding improper use, accessories and force majeure, etc.), our company will refund and replace the damaged products

warning

Do not do live-line working during installation. Make sure the input voltage meets the requirements and lines are connected correctly before lighting on.

Installation, maintenance and repair should be operated by a qualified technician.

This product will generate heat when working, considered to choose the material with good heat dissipation performance

The data given in this instruction manual is based on the standard product. Please refer to the actual product for details

All the pictures of products in this manual are schematic diagrams. For details, please refer to the actual products. The final interpretation right of this manual belongs to Lucoled NV.



LUCOLED

Experience Lighting



Lucoflex RGB-DC Manual



Please read this instruction carefully before using the product

Optional Accessories

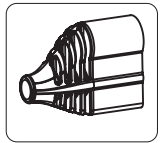

End cap with hole
(FREE)
Quantity(10m):3pcs

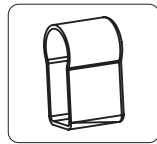

End cap without hole
(FREE)
Quantity(10m):3pcs

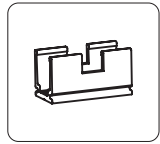

3.5cm installation
aluminum profile
(OPTIONAL)
Quantity(10m):20sets

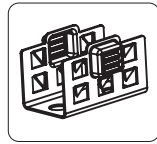

Hardware mounting clips
(OPTIONAL)
Quantity(10m):20sets

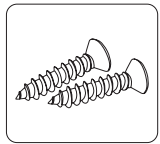

Screw (FREE)
Quantity(10m):20pcs

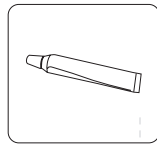

Silicone glue
(OPTIONAL)
Quantity(10m):1pcs

Controller Wiring Diagram

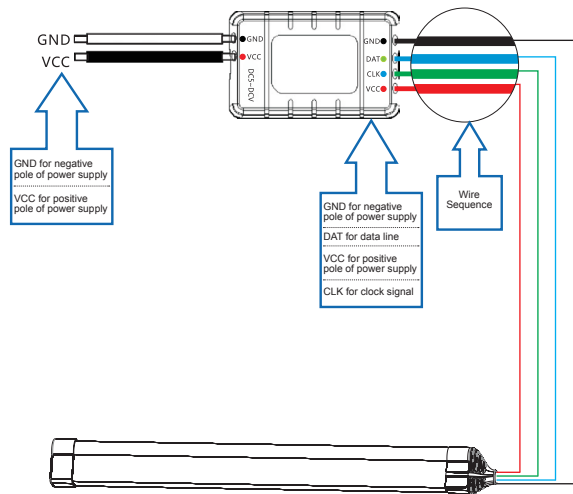

Note:

1. The controller is SP105E.
2. SP105E supports controlling with bluetooth and mobile phone APP.
3. The control distance is 20 m.
4. SP105E can drive up to 2048 pixels.
5. The input voltage of the controller ranges from DC 5V to DC 24V.
6. For additional information, please refer to the SP105E Instruction Manual.

Installation

Details of installation operation at input end

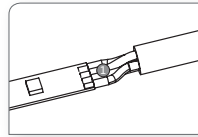

Weld the wire to the PCB board.

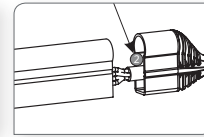

First put waterproof glue inside of the plug, then push into the tape light.

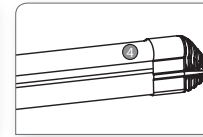

Wipe off the excess glue and wait for the glue to solidify.

Details of installation operation at the end part

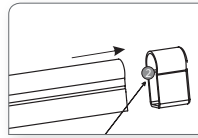

First put some glue inside of the plug, then push into the tape light

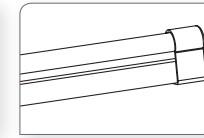

Wipe off the excess glue and wait for the glue to solidify.

Operation details of installation card

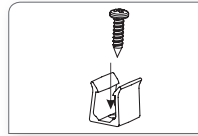

Screw the aluminum track to the installation position.

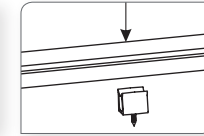

Then slowly press the tape light into the aluminum track.

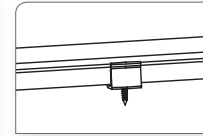

The tape light is flatly and firmly stuck on the aluminum track.

Maintain

connect the leakage protection switch, electrical source grounding, lightning protection and other supporting facilities, and designate special personnel for daily maintenance, regular inspection of switches, lines, power supply, lamp string and other products, timely repair defective products.



Controller operation diagram

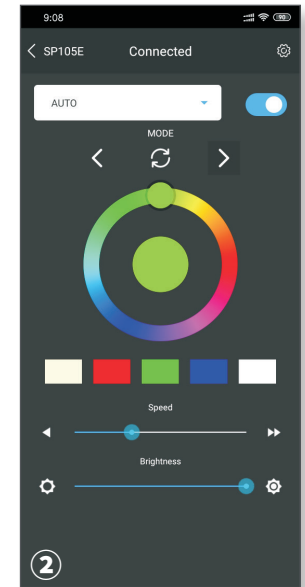
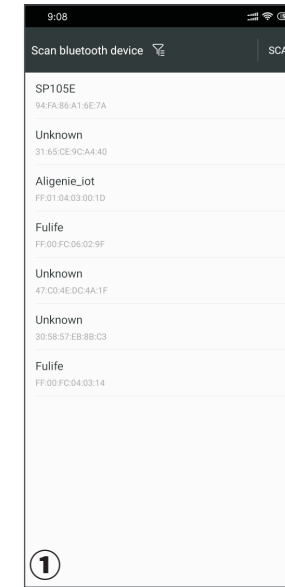

Open the APP and connect to bluetooth. Select SP105E

After entering the interface, click the gear icon in the upper right corner

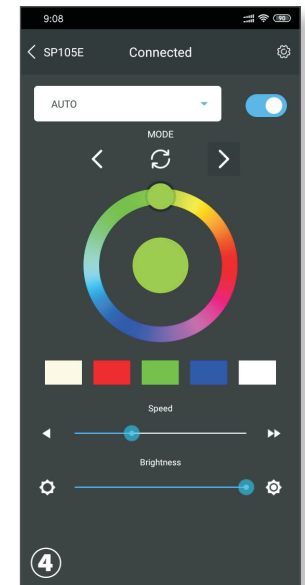
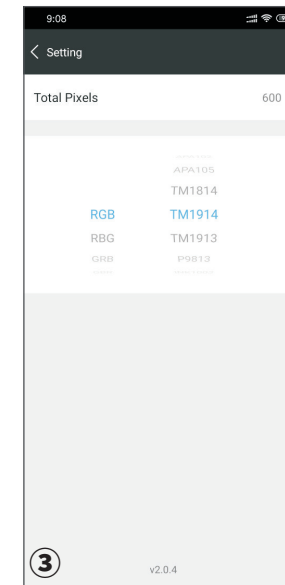

After entering the interface, select TM1914A

Go back to the effects screen and select the desired item. Go back to the effects screen and select the desired item.